



WIDIN

WIDIN

WIDIN

WIDIN

WIDIN

WIDIN

TAP DIN STANDARD *Series*

WIDIN

WIDIN





The future of WIDIN is always bright.

WIDIN share the same vision with it's customers in a way of providing top quality products at competitive price and best service, and Pursue the core management's policy "Customer-focused company".

WIDIN has grow rapidly both domestic sales and export. This performance from its innovation of technology, Quality and marketing activity.

As WIDIN's mission, will do its best to deliver customer satisfaction to around the world.

Greeting

Making customer's dreams a reality- The best mechanical solution.

Since its establishment in 1988, WIDIN CO.,LTD. has been contributed to pursue the utmost customer satisfaction for the current and potential customers in the globalized market.

With continuously doing development and creativeness of the new technology through the great initiative, we, WIDIN CO.,LTD. is always ready to response of customer needs in customer mind and eye.

To cope with the enormous, various customer demands and satisfaction from popular products to high value added products in the cutting tools industry, WIDIN CO.,LTD. will put its best effort and will play a role of marketing initiator to lead the new 21st era by production and marketing linkage.

Aim to provide the best for money, fine tuned price, utmost quality, excellent customer services based on professionalism, all WIDIN CO.,LTD. will promise to do its best effort at time and where it is.

Thank you.

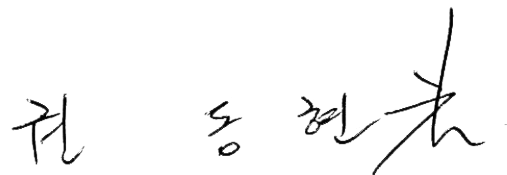
A handwritten signature in black ink, consisting of stylized Korean characters, positioned above the printed name of the President and CEO.

President and CEO Dong Hyun Kwon

TAP DIN STANDARD

POINT TAPS

TiN COATED
TiCN COATED
HOMO
UNCOATED



SPIRAL TAPS

TiN COATED
TiCN COATED
HOMO
UNCOATED



STRAIGHT TAPS

TiN COATED
TiCN COATED
HOMO
UNCOATED



ROLL TAPS

TiN COATED
TiCN COATED
UNCOATED



EDP No.

VDTM

1 The First Letter – Raw Material

V – Vanadium HSSE

2 The Second Letter – Appearance & shape

Q – Spiral Tap

D – Point Tap

M – Roll Tap

G – Straight Tap

3 The Third Letter – Coating

T – TiN Coating

C – TiCN Coating

H – HOMO

O – Uncoated

4 The Fourth Letter – Thread Size

M – Metric Coarse Screw Threads

ICON GUIDE

Raw-Material

HSSE

DIN type

DIN
371:374
376

Helix Angle



HELIX



HELIX

Coating

coated

TiN

coated

TiCN

HOMO

uncoated

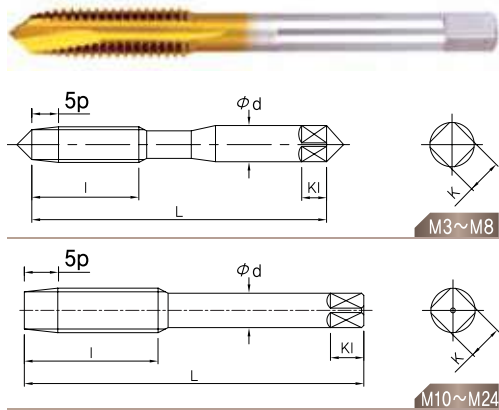

TiN coating for general use

- Designed for high performance of threading Carbon steel, Alloy steel and nonferrous metals.
- By applying TiN coating, it provides stable and highly efficient operation due to enhanced durability.



VDTM...Series

EDP NO. 5P	Thread Size	Limits	L	l	d	K	KI	Flutes	DIN Type
			Overall Length	Thread Length	Shank Diameter	Square Width	Square Length		
VDTM0305050	M3X0.5	6H	56	11.0	3.5	2.7	6	3	371
VDTM0407050	M4X0.7	6H	63	13.0	4.5	3.4	6	3	371
VDTM0508050	M5X0.8	6H	70	15.0	6.0	4.9	8	3	371
VDTM0610050	M6X1.0	6H	80	17.0	6.0	4.9	8	3	371
VDTM0810050	M8X1.0	6H	90	17.0	6.0	4.9	8	3	374
VDTM0812550	M8X1.25	6H	90	20.0	8.0	6.2	9	3	371
VDTM1010050	M10X1.0	6H	90	18.0	7.0	5.5	8	3	374
VDTM1012550	M10X1.25	6H	100	22.0	7.0	5.5	8	3	374
VDTM1015050	M10X1.5	6H	100	22.0	10.0	8.0	11	3	371
VDTM1210050	M12X1.0	6H	100	18.0	9.0	7.0	10	3	374
VDTM1212550	M12X1.25	6H	100	22.0	9.0	7.0	10	3	374
VDTM1215050	M12X1.5	6H	100	22.0	9.0	7.0	10	3	374
VDTM1217550	M12X1.75	6H	110	24.0	9.0	7.0	10	3	376
VDTM1415050	M14X1.5	6H	100	22.0	11.0	9.0	12	3	374
VDTM1420050	M14X2.0	6H	110	26.0	11.0	9.0	12	3	376
VDTM1615050	M16X1.5	6H	100	22.0	12.0	9.0	12	3	374
VDTM1620050	M16X2.0	6H	110	27.0	12.0	9.0	12	3	376
VDTM1815050	M18X1.5	6H	110	25.0	14.0	11.0	14	3	374
VDTM1825050	M18X2.5	6H	125	30.0	14.0	11.0	14	3	376
VDTM2015050	M20X1.5	6H	125	25.0	16.0	12.0	15	3	374
VDTM2025050	M20X2.5	6H	140	32.0	16.0	12.0	15	3	376
VDTM2215050	M22X1.5	6H	125	25.0	18.0	14.5	17	3	374
VDTM2225050	M22X2.5	6H	140	32.0	18.0	14.5	17	3	376
VDTM2415050	M24X1.5	6H	140	27.0	18.0	14.5	17	3	374
VDTM2420050	M24X2.0	6H	140	27.0	18.0	14.5	17	3	374
VDTM2430050	M24X3.0	6H	160	34.0	18.0	14.5	17	3	376

Low Carbon Steels	Medium Carbon Steels	High Carbon Steels	Alloy Steels	Hardened Steels			Stainless Steels	Tool Steels	Cast Steels	Cast Iron	Ductile Cast Iron	Copper	Brass	Brass Casting	Bronze	Aluminum Rolled	Aluminum Alloy Casting	Magnesium Alloy Casting	Zinc Alloy Casting	Titanium Alloys	Nickel Alloys	Thermo Setting Plastic	Thermo Plastic
C ~0.25%	C 0.25% ~0.45%	C 0.45%~	SCM	25~45 HRC	45~55 HRC	50~60 HRC	SUS	SKD	SC	FC	FCD	Cu	Bs	BsC	BRZ	AL	AC,ADC	MC	ZDC				
○	○	○	○				◎	○	○	○	○	○	○	○	○	○	○	○	○	○	○		○

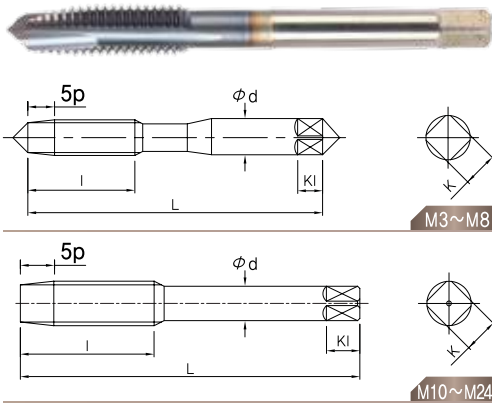

TiCN coating for general use

- Designed for high performance of threading Carbon steel, Alloy steel and nonferrous metals.
- By applying TiCN coating, it provides stable and highly efficient operation due to enhanced durability.



VDCM...Series

EDP NO. 5P	Thread Size	Limits	L	l	d	K	KI	Flutes	DiN Type
			Overall Length	Thread Length	Shank Diameter	Square Width	Square Length		
VDCM0305050	M3X0.5	6H	56	11.0	3.5	2.7	6	3	371
VDCM0407050	M4X0.7	6H	63	13.0	4.5	3.4	6	3	371
VDCM0508050	M5X0.8	6H	70	15.0	6.0	4.9	8	3	371
VDCM0610050	M6X1.0	6H	80	17.0	6.0	4.9	8	3	371
VDCM0810050	M8X1.0	6H	90	17.0	6.0	4.9	8	3	374
VDCM0812550	M8X1.25	6H	90	20.0	8.0	6.2	9	3	371
VDCM1010050	M10X1.0	6H	90	18.0	7.0	5.5	8	3	374
VDCM1012550	M10X1.25	6H	100	22.0	7.0	5.5	8	3	374
VDCM1015050	M10X1.5	6H	100	22.0	10.0	8.0	11	3	371
VDCM1210050	M12X1.0	6H	100	18.0	9.0	7.0	10	3	374
VDCM1212550	M12X1.25	6H	100	22.0	9.0	7.0	10	3	374
VDCM1215050	M12X1.5	6H	100	22.0	9.0	7.0	10	3	374
VDCM1217550	M12X1.75	6H	110	24.0	9.0	7.0	10	3	371
VDCM1415050	M14X1.5	6H	100	22.0	11.0	9.0	12	3	374
VDCM1420050	M14X2.0	6H	110	26.0	11.0	9.0	12	3	376
VDCM1615050	M16X1.5	6H	100	22.0	12.0	9.0	12	3	374
VDCM1620050	M16X2.0	6H	110	27.0	12.0	9.0	12	3	376
VDCM1815050	M18X1.5	6H	110	25.0	14.0	11.0	14	3	374
VDCM1825050	M18X2.5	6H	125	30.0	14.0	11.0	14	3	376
VDCM2015050	M20X1.5	6H	125	25.0	16.0	12.0	15	3	374
VDCM2025050	M20X2.5	6H	140	32.0	16.0	12.0	15	3	376
VDCM2215050	M22X1.5	6H	125	25.0	18.0	14.5	17	3	374
VDCM2225050	M22X2.5	6H	140	32.0	18.0	14.5	17	3	376
VDCM2415050	M24X1.5	6H	140	27.0	18.0	14.5	17	3	374
VDCM2420050	M24X2.0	6H	140	27.0	18.0	14.5	17	3	374
VDCM2430050	M24X3.0	6H	160	34.0	18.0	14.5	17	3	376

Low Carbon Steels	Medium Carbon Steels	High Carbon Steels	Alloy Steels	Hardened Steels			Stainless Steels	Tool Steels	Cast Steels	Cast Iron	Ductile Cast Iron	Copper	Brass	Brass Casting	Bronze	Aluminum Rolled	Aluminum Alloy Casting	Magnesium Alloy Casting	Zinc Alloy Casting	Titanium Alloys	Nickel Alloys	Thermo Setting Plastic	Thermo Plastic
C ~0.25%	C0.25% ~0.45%	C 0.45%~	SCM	25~45 HRc	45~55 HRc	50~60 HRc	SUS	SKD	SC	FC	FCD	Cu	Bs	BsC	BRZ	AL	AC,ADC	MC	ZDC				
○	○	○	○				○	○	○	○	○	○	○	○	○	○	○	○	○	○	○		○

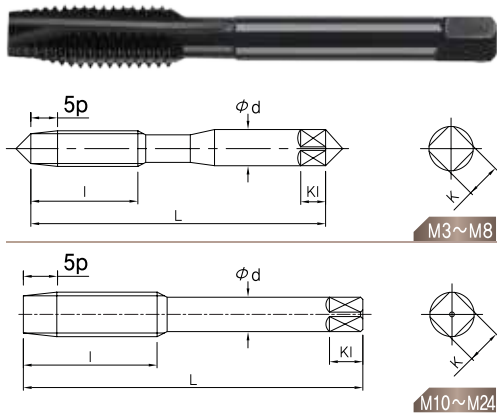

HOMO for general use

- Designed for high performance of threading Carbon steel, Alloy steel and nonferrous metals.
- By applying HOMO, it provides stable and highly efficient operation due to enhanced durability.



VDHM...Series

EDP NO. 5P	Thread Size	Limits	L	l	d	K	KI	Flutes	DIN Type
			Overall Length	Thread Length	Shank Diameter	Square Width	Square Length		
VDHM0305050	M3X0.5	6H	56	11.0	3.5	2.7	6	3	371
VDHM0407050	M4X0.7	6H	63	13.0	4.5	3.4	6	3	371
VDHM0508050	M5X0.8	6H	70	15.0	6.0	4.9	8	3	371
VDHM0610050	M6X1.0	6H	80	17.0	6.0	4.9	8	3	371
VDHM0810050	M8X1.0	6H	90	17.0	6.0	4.9	8	3	374
VDHM0812550	M8X1.25	6H	90	20.0	8.0	6.2	9	3	371
VDHM1010050	M10X1.0	6H	90	18.0	7.0	5.5	8	3	374
VDHM1012550	M10X1.25	6H	100	22.0	7.0	5.5	8	3	374
VDHM1015050	M10X1.5	6H	100	22.0	10.0	8.0	11	3	371
VDHM1210050	M12X1.0	6H	100	18.0	9.0	7.0	10	3	374
VDHM1212550	M12X1.25	6H	100	22.0	9.0	7.0	10	3	374
VDHM1215050	M12X1.5	6H	100	22.0	9.0	7.0	10	3	374
VDHM1217550	M12X1.75	6H	110	24.0	9.0	7.0	10	3	371
VDHM1415050	M14X1.5	6H	100	22.0	11.0	9.0	12	3	374
VDHM1420050	M14X2.0	6H	110	26.0	11.0	9.0	12	3	376
VDHM1615050	M16X1.5	6H	100	22.0	12.0	9.0	12	3	374
VDHM1620050	M16X2.0	6H	110	27.0	12.0	9.0	12	3	376
VDHM1815050	M18X1.5	6H	110	25.0	14.0	11.0	14	3	374
VDHM1825050	M18X2.5	6H	125	30.0	14.0	11.0	14	3	376
VDHM2015050	M20X1.5	6H	125	25.0	16.0	12.0	15	3	374
VDHM2025050	M20X2.5	6H	140	32.0	16.0	12.0	15	3	376
VDHM2215050	M22X1.5	6H	125	25.0	18.0	14.5	17	3	374
VDHM2225050	M22X2.5	6H	140	32.0	18.0	14.5	17	3	376
VDHM2415050	M24X1.5	6H	140	27.0	18.0	14.5	17	3	374
VDHM2420050	M24X2.0	6H	140	27.0	18.0	14.5	17	3	374
VDHM2430050	M24X3.0	6H	160	34.0	18.0	14.5	17	3	376

Low Carbon Steels	Medium Carbon Steels	High Carbon Steels	Alloy Steels	Hardened Steels			Stainless Steels	Tool Steels	Cast Steels	Cast Iron	Ductile Cast Iron	Copper	Brass	Brass Casting	Bronze	Aluminum Rolled	Aluminum Alloy Casting	Magnesium Alloy Casting	Zinc Alloy Casting	Titanium Alloys	Nickel Alloys	Thermo Setting Plastic	Thermo Plastic
C ~0.25%	C0.25% ~0.45%	C 0.45%~	SCM	25~45 HRc	45~55 HRc	50~60 HRc	SUS	SKD	SC	FC	FCD	Cu	Bs	BsC	BRZ	AL	AC,ADC	MC	ZDC				
○	○		○						○														○

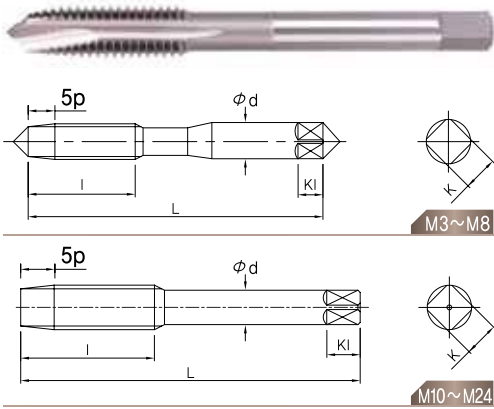

Uncoated for general use

- Designed for high performance of threading
Carbon steel, Alloy steel and nonferrous metals.

VDOM...Series



EDP NO. 5P	Thread Size	Limits	L	l	d	K	KI	Flutes	DIN Type
			Overall Length	Thread Length	Shank Diameter	Square Width	Square Length		
VDOM0305050	M3X0.5	6H	56	11.0	3.5	2.7	6	3	371
VDOM0407050	M4X0.7	6H	63	13.0	4.5	3.4	6	3	371
VDOM0508050	M5X0.8	6H	70	15.0	6.0	4.9	8	3	371
VDOM0610050	M6X1.0	6H	80	17.0	6.0	4.9	8	3	371
VDOM0810050	M8X1.0	6H	90	17.0	6.0	4.9	8	3	374
VDOM0812550	M8X1.25	6H	90	20.0	8.0	6.2	9	3	371
VDOM1010050	M10X1.0	6H	90	18.0	7.0	5.5	8	3	374
VDOM1012550	M10X1.25	6H	100	22.0	7.0	5.5	8	3	374
VDOM1015050	M10X1.5	6H	100	22.0	10.0	8.0	11	3	371
VDOM1210050	M12X1.0	6H	100	18.0	9.0	7.0	10	3	374
VDOM1212550	M12X1.25	6H	100	22.0	9.0	7.0	10	3	374
VDOM1215050	M12X1.5	6H	100	22.0	9.0	7.0	10	3	374
VDOM1217550	M12X1.75	6H	110	24.0	9.0	7.0	10	3	376
VDOM1415050	M14X1.5	6H	100	22.0	11.0	9.0	12	3	374
VDOM1420050	M14X2.0	6H	110	26.0	11.0	9.0	12	3	376
VDOM1615050	M16X1.5	6H	100	22.0	12.0	9.0	12	3	374
VDOM1620050	M16X2.0	6H	110	27.0	12.0	9.0	12	3	376
VDOM1815050	M18X1.5	6H	110	25.0	14.0	11.0	14	3	374
VDOM1825050	M18X2.5	6H	125	30.0	14.0	11.0	14	3	376
VDOM2015050	M20X1.5	6H	125	25.0	16.0	12.0	15	3	374
VDOM2025050	M20X2.5	6H	140	32.0	16.0	12.0	15	3	376
VDOM2215050	M22X1.5	6H	125	25.0	18.0	14.5	17	3	374
VDOM2225050	M22X2.5	6H	140	32.0	18.0	14.5	17	3	376
VDOM2415050	M24X1.5	6H	140	27.0	18.0	14.5	17	3	374
VDOM2420050	M24X2.0	6H	140	27.0	18.0	14.5	17	3	374
VDOM2430050	M24X3.0	6H	160	34.0	18.0	14.5	17	3	376

Low Carbon Steels	Medium Carbon Steels	High Carbon Steels	Alloy Steels	Hardened Steels			Stainless Steels	Tool Steels	Cast Steels	Cast Iron	Ductile Cast Iron	Copper	Brass	Brass Casting	Bronze	Aluminum Rolled	Aluminum Alloy Casting	Magnesium Alloy Casting	Zinc Alloy Casting	Titanium Alloys	Nickel Alloys	Thermo Setting Plastic	Thermo Plastic
C ~0.25%	C 0.25% ~0.45%	C 0.45%~	SCM	25~45 HRc	45~55 HRc	50~60 HRc	SUS	SKD	SC	FC	FCD	Cu	Bs	BsC	BRZ	AL	AC,ADC	MC	ZDC				
	○	○	◎								○	○	○	○	○	◎	○	○	○				○

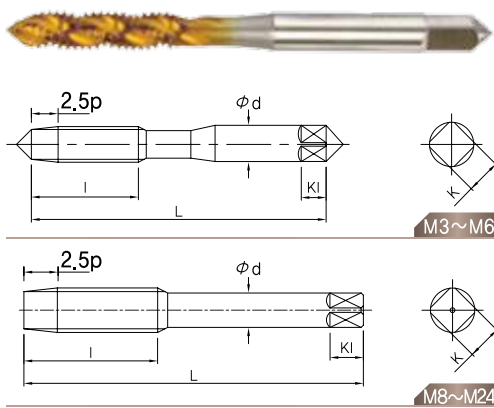

TiN coating for general use

- Suitable for Carbon steel, Alloy steel and Nonferrous metals and the unique shape of the groove is designed for high release of chips.
- By applying TiN coating, it provides stable and highly efficient operation due to enhanced durability.

VQTM...Series



EDP NO. 2.5P	Thread Size	Limits	L	l	d	K	KI	Flutes	DIN Type
			Overall Length	Thread Length	Shank Diameter	Square Width	Square Length		
VQTM0305025	M3X0.5	6H	56	11.0	3.5	2.7	6	3	371
VQTM0407025	M4X0.7	6H	63	13.0	4.5	3.4	6	3	371
VQTM0508025	M5X0.8	6H	70	15.0	6.0	4.9	8	3	371
VQTM0610025	M6X1.0	6H	80	17.0	6.0	4.9	8	3	371
VQTM0810025	M8X1.0	6H	90	17.0	6.0	4.9	8	3	374
VQTM0812525	M8X1.25	6H	90	20.0	8.0	6.2	9	3	371
VQTM1010025	M10X1.0	6H	90	18.0	7.0	5.5	8	3	374
VQTM1012525	M10X1.25	6H	100	22.0	7.0	5.5	8	3	374
VQTM1015025	M10X1.5	6H	100	22.0	10.0	8.0	11	3	371
VQTM1210025	M12X1.0	6H	100	18.0	9.0	7.0	10	3	374
VQTM1212525	M12X1.25	6H	100	22.0	9.0	7.0	10	3	374
VQTM1215025	M12X1.5	6H	100	22.0	9.0	7.0	10	3	374
VQTM1217525	M12X1.75	6H	110	24.0	9.0	7.0	10	3	376
VQTM1415025	M14X1.5	6H	100	22.0	11.0	9.0	12	3	374
VQTM1420025	M14X2.0	6H	110	26.0	11.0	9.0	12	3	376
VQTM1615025	M16X1.5	6H	100	22.0	12.0	9.0	12	3	374
VQTM1620025	M16X2.0	6H	110	27.0	12.0	9.0	12	3	376
VQTM1815025	M18X1.5	6H	110	25.0	14.0	11.0	14	4	374
VQTM1825025	M18X2.5	6H	125	30.0	14.0	11.0	14	4	376
VQTM2015025	M20X1.5	6H	125	25.0	16.0	12.0	15	4	374
VQTM2025025	M20X2.5	6H	140	32.0	16.0	12.0	15	4	376
VQTM2215025	M22X1.5	6H	125	25.0	18.0	14.5	17	4	374
VQTM2225025	M22X2.5	6H	140	32.0	18.0	14.5	17	4	376
VQTM2415025	M24X1.5	6H	140	27.0	18.0	14.5	17	4	374
VQTM2420025	M24X2.0	6H	140	27.0	18.0	14.5	17	4	374
VQTM2430025	M24X3.0	6H	160	34.0	18.0	14.5	17	4	376

Low Carbon Steels	Medium Carbon Steels	High Carbon Steels	Alloy Steels	Hardened Steels			Stainless Steels	Tool Steels	Cast Steels	Cast Iron	Ductile Cast Iron	Copper	Brass	Brass Casting	Bronze	Aluminum Rolled	Aluminum Alloy Casting	Magnesium Alloy Casting	Zinc Alloy Casting	Titanium Alloys	Nickel Alloys	Thermo Setting Plastic	Thermo Plastic
C ~0.25%	C 0.25% ~0.45%	C 0.45%~	SCM	25~45 HRc	45~55 HRc	50~60 HRc	SUS	SKD	SC	FC	FCD	Cu	Bs	BsC	BRZ	AL	AC,ADC	MC	ZDC				
○	○	○	○				○	○	○		○	○	○	○	○	○	○	○	○	○			○

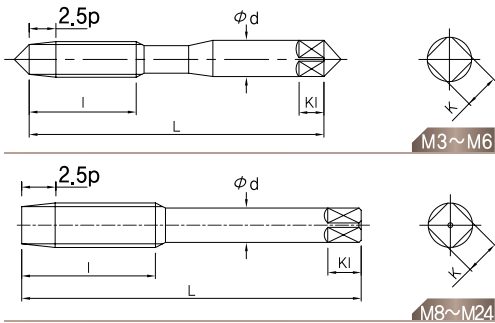

TiCN coating for general use

- Suitable for Carbon steel, Alloy steel and Nonferrous metals and the unique shape of the groove is designed for high release of chips.
- By applying TiCN coating, it provides stable and highly efficient operation due to enhanced durability.



VQCM...Series

EDP NO. 2.5P	Thread Size	Limits	L	l	d	K	KI	Flutes	DIN Type
			Overall Length	Thread Length	Shank Diameter	Square Width	Square Length		
VQCM0305025	M3X0.5	6H	56	11.0	3.5	2.7	6	3	371
VQCM0407025	M4X0.7	6H	63	13.0	4.5	3.4	6	3	371
VQCM0508025	M5X0.8	6H	70	15.0	6.0	4.9	8	3	371
VQCM0610025	M6X1.0	6H	80	17.0	6.0	4.9	8	3	371
VQCM0810025	M8X1.0	6H	90	17.0	6.0	4.9	8	3	374
VQCM0812525	M8X1.25	6H	90	20.0	8.0	6.2	9	3	371
VQCM1010025	M10X1.0	6H	90	18.0	7.0	5.5	8	3	374
VQCM1012525	M10X1.25	6H	100	22.0	7.0	5.5	8	3	374
VQCM1015025	M10X1.5	6H	100	22.0	10.0	8.0	11	3	371
VQCM1210025	M12X1.0	6H	100	18.0	9.0	7.0	10	3	374
VQCM1212525	M12X1.25	6H	100	22.0	9.0	7.0	10	3	374
VQCM1215025	M12X1.5	6H	100	22.0	9.0	7.0	10	3	374
VQCM1217525	M12X1.75	6H	110	24.0	9.0	7.0	10	3	376
VQCM1415025	M14X1.5	6H	100	22.0	11.0	9.0	12	3	374
VQCM1420025	M14X2.0	6H	110	26.0	11.0	9.0	12	3	376
VQCM1615025	M16X1.5	6H	100	22.0	12.0	9.0	12	3	374
VQCM1620025	M16X2.0	6H	110	27.0	12.0	9.0	12	3	376
VQCM1815025	M18X1.5	6H	110	25.0	14.0	11.0	14	4	374
VQCM1825025	M18X2.5	6H	125	30.0	14.0	11.0	14	4	376
VQCM2015025	M20X1.5	6H	125	25.0	16.0	12.0	15	4	374
VQCM2025025	M20X2.5	6H	140	32.0	16.0	12.0	15	4	376
VQCM2215025	M22X1.5	6H	125	25.0	18.0	14.5	17	4	374
VQCM2225025	M22X2.5	6H	140	32.0	18.0	14.5	17	4	376
VQCM2415025	M24X1.5	6H	140	27.0	18.0	14.5	17	4	374
VQCM2420025	M24X2.0	6H	140	27.0	18.0	14.5	17	4	374
VQCM2430025	M24X3.0	6H	160	34.0	18.0	14.5	17	4	376

Low Carbon Steels	Medium Carbon Steels	High Carbon Steels	Alloy Steels	Hardened Steels	Stainless Steels	Tool Steels	Cast Steels	Cast Iron	Ductile Cast Iron	Copper	Brass	Brass Casting	Bronze	Aluminum Rolled	Aluminum Alloy Casting	Magnesium Alloy Casting	Zinc Alloy Casting	Titanium Alloys	Nickel Alloys	Thermo Setting Plastic	Thermo Plastic
C ~0.25%	C 0.25% ~0.45%	C 0.45%~	SCM	25~45 HRc 45~55 HRc 50~60 HRc	SUS	SKD	SC	FC	FCD	Cu	Bs	BsC	BRZ	AL	AC,ADC	MC	ZDC				
○	○	○	○		○	○	○		○	○	○	○	○	○	○	○	○	○	○		○

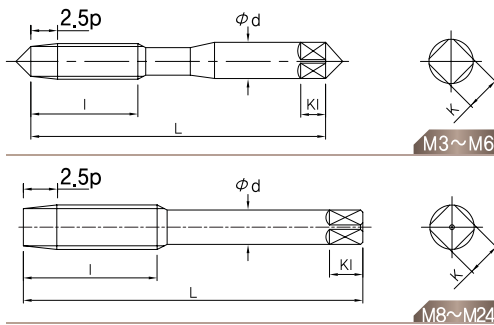

HOMO for general use

- Suitable for Carbon steel, Alloy steel and Nonferrous metals and the unique shape of the groove is designed for high release of chips.

VQHM...Series



EDP NO. 2.5P	Thread Size	Limits	L	l	d	K	KI	Flutes	DIN Type
			Overall Length	Thread Length	Shank Diameter	Square Width	Square Length		
VQHM0305025	M3X0.5	6H	56	11.0	3.5	2.7	6	3	371
VQHM0407025	M4X0.7	6H	63	13.0	4.5	3.4	6	3	371
VQHM0508025	M5X0.8	6H	70	15.0	6.0	4.9	8	3	371
VQHM0610025	M6X1.0	6H	80	17.0	6.0	4.9	8	3	371
VQHM0810025	M8X1.0	6H	90	17.0	6.0	4.9	8	3	374
VQHM0812525	M8X1.25	6H	90	20.0	8.0	6.2	9	3	371
VQHM1010025	M10X1.0	6H	90	18.0	7.0	5.5	8	3	374
VQHM1012525	M10X1.25	6H	100	22.0	7.0	5.5	8	3	374
VQHM1015025	M10X1.5	6H	100	22.0	10.0	8.0	11	3	371
VQHM1210025	M12X1.0	6H	100	18.0	9.0	7.0	10	3	374
VQHM1212525	M12X1.25	6H	100	22.0	9.0	7.0	10	3	374
VQHM1215025	M12X1.5	6H	100	22.0	9.0	7.0	10	3	374
VQHM1217525	M12X1.75	6H	110	24.0	9.0	7.0	10	3	376
VQHM1415025	M14X1.5	6H	100	22.0	11.0	9.0	12	3	374
VQHM1420025	M14X2.0	6H	110	26.0	11.0	9.0	12	3	376
VQHM1615025	M16X1.5	6H	100	22.0	12.0	9.0	12	3	374
VQHM1620025	M16X2.0	6H	110	27.0	12.0	9.0	12	3	376
VQHM1815025	M18X1.5	6H	110	25.0	14.0	11.0	14	4	374
VQHM1825025	M18X2.5	6H	125	30.0	14.0	11.0	14	4	376
VQHM2015025	M20X1.5	6H	125	25.0	16.0	12.0	15	4	374
VQHM2025025	M20X2.5	6H	140	32.0	16.0	12.0	15	4	376
VQHM2215025	M22X1.5	6H	125	25.0	18.0	14.5	17	4	374
VQHM2225025	M22X2.5	6H	140	32.0	18.0	14.5	17	4	376
VQHM2415025	M24X1.5	6H	140	27.0	18.0	14.5	17	4	374
VQHM2420025	M24X2.0	6H	140	27.0	18.0	14.5	17	4	374
VQHM2430025	M24X3.0	6H	160	34.0	18.0	14.5	17	4	376

Low Carbon Steels	Medium Carbon Steels	High Carbon Steels	Alloy Steels	Hardened Steels	Stainless Steels	Tool Steels	Cast Steels	Cast Iron	Ductile Cast Iron	Copper	Brass	Brass Casting	Bronze	Aluminum Rolled	Aluminum Alloy Casting	Magnesium Alloy Casting	Zinc Alloy Casting	Titanium Alloys	Nickel Alloys	Thermo Setting Plastic	Thermo Plastic	
C ~0.25%	C0.25% ~0.45%	C 0.45%~	SCM	25~45 HRc 45~55 HRc 50~60 HRc	SUS	SKD	SC	FC	FCD	Cu	Bs	BsC	BRZ	AL	AC,ADC	MC	ZDC					
○	○						○															○

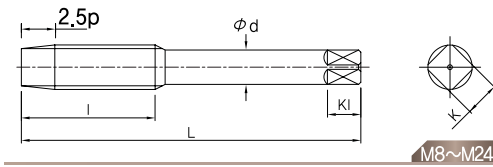
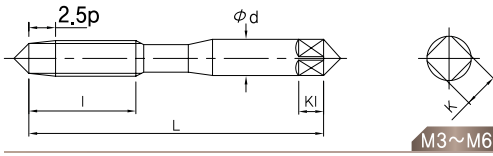

Uncoated for general use

- Suitable for Carbon steel, Alloy steel and Nonferrous metals and the unique shape of the groove is designed for high release of chips.



VQOM...Series

EDP NO. 2.5P	Thread size	Limits	L	l	d	K	KI	Flutes	DiN Type
			Overall Length	Thread Length	Shank Diameter	Square Width	Square Length		
VQOM0305025	M3X0.5	6H	56	11.0	3.5	2.7	6	3	371
VQOM0407025	M4X0.7	6H	63	13.0	4.5	3.4	6	3	371
VQOM0508025	M5X0.8	6H	70	15.0	6.0	4.9	8	3	371
VQOM0610025	M6X1.0	6H	80	17.0	6.0	4.9	8	3	371
VQOM0810025	M8X1.0	6H	90	17.0	6.0	4.9	8	3	374
VQOM0812525	M8X1.25	6H	90	20.0	8.0	6.2	9	3	371
VQOM1010025	M10X1.0	6H	90	18.0	7.0	5.5	8	3	374
VQOM1012525	M10X1.25	6H	100	22.0	7.0	5.5	8	3	374
VQOM1015025	M10X1.5	6H	100	22.0	10.0	8.0	11	3	371
VQOM1210025	M12X1.0	6H	100	18.0	9.0	7.0	10	3	374
VQOM1212525	M12X1.25	6H	100	22.0	9.0	7.0	10	3	374
VQOM1215025	M12X1.5	6H	100	22.0	9.0	7.0	10	3	374
VQOM1217525	M12X1.75	6H	110	24.0	9.0	7.0	10	3	376
VQOM1415025	M14X1.5	6H	100	22.0	11.0	9.0	12	3	374
VQOM1420025	M14X2.0	6H	110	26.0	11.0	9.0	12	3	376
VQOM1615025	M16X1.5	6H	100	22.0	12.0	9.0	12	3	374
VQOM1620025	M16X2.0	6H	110	27.0	12.0	9.0	12	3	376
VQOM1815025	M18X1.5	6H	110	25.0	14.0	11.0	14	4	374
VQOM1825025	M18X2.5	6H	125	30.0	14.0	11.0	14	4	376
VQOM2015025	M20X1.5	6H	125	25.0	16.0	12.0	15	4	374
VQOM2025025	M20X2.5	6H	140	32.0	16.0	12.0	15	4	376
VQOM2215025	M22X1.5	6H	125	25.0	18.0	14.5	17	4	374
VQOM2225025	M22X2.5	6H	140	32.0	18.0	14.5	17	4	376
VQOM2415025	M24X1.5	6H	140	27.0	18.0	14.5	17	4	374
VQOM2420025	M24X2.0	6H	140	27.0	18.0	14.5	17	4	374
VQOM2430025	M24X3.0	6H	160	34.0	18.0	14.5	17	4	376

Low Carbon Steels	Medium Carbon Steels	High Carbon Steels	Alloy Steels	Hardened Steels			Stainless Steels	Tool Steels	Cast Steels	Cast Iron	Ductile Cast Iron	Copper	Brass	Brass Casting	Bronze	Aluminum Rolled	Aluminum Alloy Casting	Magnesium Alloy Casting	Zinc Alloy Casting	Titanium Alloys	Nickel Alloys	Thermo Setting Plastic	Thermo Plastic
C ~0.25%	C0.25% ~0.45%	C 0.45%~	SCM	25~45 HRc	45~55 HRc	50~60 HRc	SUS	SKD	SC	FC	FCD	Cu	Bs	BsC	BRZ	AL	AC,ADC	MC	ZDC				
	○		◎								○	○	○	○	○	○	○	○	○				○

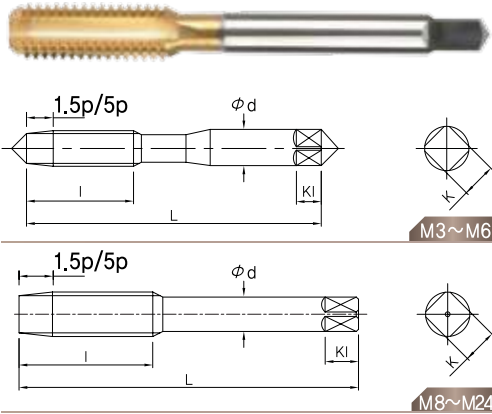

TiN coating for general use

- Designed for high performance of threading Carbon steel, Alloy steel and Nonferrous metals.
- By applying TiN coating, it provides stable and highly efficient operation due to enhanced durability.

VGTM...Series



EDP NO.		Thread size	Limits	L	l	d	K	KI	Flutes	DiN Type
1.5P	5P			Overall Length	Thread Length	Shank Diameter	Square Width	Square Length		
VGTM0305015	VGTM0305050	M3X0.5	6H	56	11.0	3.5	2.7	6	3	371
VGTM0407015	VGTM0407050	M4X0.7	6H	63	13.0	4.5	3.4	6	3	371
VGTM0508015	VGTM0508050	M5X0.8	6H	70	15.0	6.0	4.9	8	3	371
VGTM0610015	VGTM0610050	M6X1.0	6H	80	17.0	6.0	4.9	8	3	371
VGTM0810015	VGTM0810050	M8X1.0	6H	90	17.0	6.0	4.9	8	4	374
VGTM0812515	VGTM0812550	M8X1.25	6H	90	20.0	8.0	6.2	9	4	371
VGTM1010015	VGTM1010050	M10X1.0	6H	90	18.0	7.0	5.5	8	4	374
VGTM1012515	VGTM1012550	M10X1.25	6H	100	22.0	7.0	5.5	8	4	374
VGTM1015015	VGTM1015050	M10X1.5	6H	100	22.0	10.0	8.0	11	4	371
VGTM1210015	VGTM1210050	M12X1.0	6H	100	18.0	9.0	7.0	10	4	374
VGTM1212515	VGTM1212550	M12X1.25	6H	100	22.0	9.0	7.0	10	4	374
VGTM1215015	VGTM1215050	M12X1.5	6H	100	22.0	9.0	7.0	10	4	374
VGTM1217515	VGTM1217550	M12X1.75	6H	110	24.0	9.0	7.0	10	4	376
VGTM1415015	VGTM1415050	M14X1.5	6H	100	22.0	11.0	9.0	12	4	374
VGTM1420015	VGTM1420050	M14X2.0	6H	110	26.0	11.0	9.0	12	4	376
VGTM1615015	VGTM1615050	M16X1.5	6H	100	22.0	12.0	9.0	12	4	374
VGTM1620015	VGTM1620050	M16X2.0	6H	110	27.0	12.0	9.0	12	4	376
VGTM1815015	VGTM1815050	M18X1.5	6H	110	25.0	14.0	11.0	14	4	374
VGTM1825015	VGTM1825050	M18X2.5	6H	125	30.0	14.0	11.0	14	4	376
VGTM2015015	VGTM2015050	M20X1.5	6H	125	25.0	16.0	12.0	15	4	374
VGTM2025015	VGTM2025050	M20X2.5	6H	140	32.0	16.0	12.0	15	4	376
VGTM2215015	VGTM2215050	M22X1.5	6H	125	25.0	18.0	14.5	17	4	374
VGTM2225015	VGTM2225050	M22X2.5	6H	140	32.0	18.0	14.5	17	4	376
VGTM2415015	VGTM2415050	M24X1.5	6H	140	27.0	18.0	14.5	17	4	374
VGTM2420015	VGTM2420050	M24X2.0	6H	140	27.0	18.0	14.5	17	4	374
VGTM2430015	VGTM2430050	M24X3.0	6H	160	34.0	18.0	14.5	17	4	376

Low Carbon Steels	Medium Carbon Steels	High Carbon Steels	Alloy Steels	Hardened Steels			Stainless Steels	Tool Steels	Cast Steels	Cast Iron	Ductile Cast Iron	Copper	Brass	Brass Casting	Bronze	Aluminum Rolled	Aluminum Alloy Casting	Magnesium Alloy Casting	Zinc Alloy Casting	Titanium Alloys	Nickel Alloys	Thermo Setting Plastic	Thermo Plastic
C ~0.25%	C0.25% ~0.45%	C 0.45%~	SCM	25~45 HRc	45~55 HRc	50~60 HRc	SUS	SKD	SC	FC	FCD	Cu	Bs	BsC	BRZ	AL	AC,ADC	MC	ZDC				
○	○	○	○	○									○	○	○	○	○	○	○				

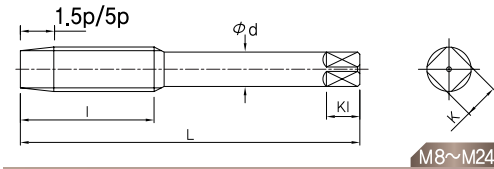
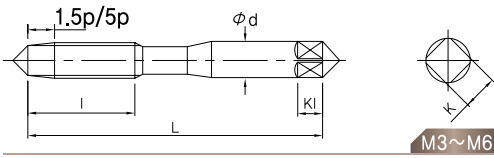

TiCN coating for general use

- Designed for high performance of threading Carbon steel, Alloy steel and Nonferrous metals.
- By applying TiCN coating, it provides stable and highly efficient operation due to enhanced durability.



VGCM...Series

EDP NO.		Thread size	Limits	L	l	d	K	KI	Flutes	DiN Type
1,5P	5P			Overall Length	Thread Length	Shank Diameter	Square Width	Square Length		
VGCM0305015	VGCM0305050	M3X0,5	6H	56	11,0	3,5	2,7	6	3	371
VGCM0407015	VGCM0407050	M4X0,7	6H	63	13,0	4,5	3,4	6	3	371
VGCM0508015	VGCM0508050	M5X0,8	6H	70	15,0	6,0	4,9	8	3	371
VGCM0610015	VGCM0610050	M6X1,0	6H	80	17,0	6,0	4,9	8	3	371
VGCM0810015	VGCM0810050	M8X1,0	6H	90	17,0	6,0	4,9	8	4	374
VGCM0812515	VGCM0812550	M8X1,25	6H	90	20,0	8,0	6,2	9	4	371
VGCM1010015	VGCM1010050	M10X1,0	6H	90	18,0	7,0	5,5	8	4	374
VGCM1012515	VGCM1012550	M10X1,25	6H	100	22,0	7,0	5,5	8	4	374
VGCM1015015	VGCM1015050	M10X1,5	6H	100	22,0	10,0	8,0	11	4	371
VGCM1210015	VGCM1210050	M12X1,0	6H	100	18,0	9,0	7,0	10	4	374
VGCM1212515	VGCM1212550	M12X1,25	6H	100	22,0	9,0	7,0	10	4	374
VGCM1215015	VGCM1215050	M12X1,5	6H	100	22,0	9,0	7,0	10	4	374
VGCM1217515	VGCM1217550	M12X1,75	6H	110	24,0	9,0	7,0	10	4	376
VGCM1415015	VGCM1415050	M14X1,5	6H	100	22,0	11,0	9,0	12	4	374
VGCM1420015	VGCM1420050	M14X2,0	6H	110	26,0	11,0	9,0	12	4	376
VGCM1615015	VGCM1615050	M16X1,5	6H	100	22,0	12,0	9,0	12	4	374
VGCM1620015	VGCM1620050	M16X2,0	6H	110	27,0	12,0	9,0	12	4	376
VGCM1815015	VGCM1815050	M18X1,5	6H	110	25,0	14,0	11,0	14	4	374
VGCM1825015	VGCM1825050	M18X2,5	6H	125	30,0	14,0	11,0	14	4	376
VGCM2015015	VGCM2015050	M20X1,5	6H	125	25,0	16,0	12,0	15	4	374
VGCM2025015	VGCM2025050	M20X2,5	6H	140	32,0	16,0	12,0	15	4	376
VGCM2215015	VGCM2215050	M22X1,5	6H	125	25,0	18,0	14,5	17	4	374
VGCM2225015	VGCM2225050	M22X2,5	6H	140	32,0	18,0	14,5	17	4	376
VGCM2415015	VGCM2415050	M24X1,5	6H	140	27,0	18,0	14,5	17	4	374
VGCM2420015	VGCM2420050	M24X2,0	6H	140	27,0	18,0	14,5	17	4	374
VGCM2430015	VGCM2430050	M24X3,0	6H	160	34,0	18,0	14,5	17	4	376

Low Carbon Steels	Medium Carbon Steels	High Carbon Steels	Alloy Steels	Hardened Steels			Stainless Steels	Tool Steels	Cast Steels	Cast Iron	Ductile Cast Iron	Copper	Brass	Brass Casting	Bronze	Aluminum Rolled	Aluminum Alloy Casting	Magnesium Alloy Casting	Zinc Alloy Casting	Titanium Alloys	Nickel Alloys	Thermo Setting Plastic	Thermo Plastic
C ~0,25%	C 0,25% ~0,45%	C 0,45%~	SCM	25~45 HRC	45~55 HRC	50~60 HRC	SUS	SKD	SC	FC	FCD	Cu	Bs	BsC	BRZ	AL	AC,ADC	MC	ZDC				
○	○	○	○	○									○	○	○	○	○	○	○				

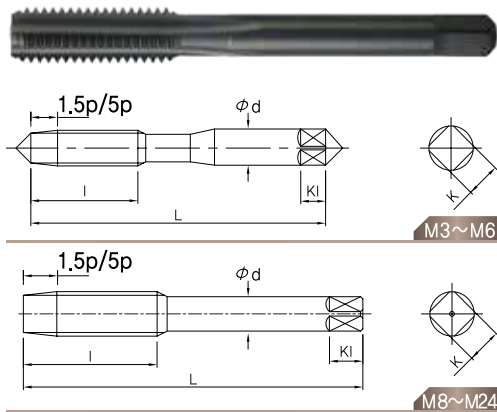

HOMO for general use

- Designed for high performance of threading Carbon steel, Alloy steel and Nonferrous metals.
- By applying HOMO, it provides stable and highly efficient operation due to enhanced durability.

VGHM...Series



EDP NO.		Thread size	Limits	L	l	d	K	KI	Flutes	DiN Type
1,5P	5P			Overall Length	Thread Length	Shank Diameter	Square Width	Square Length		
VGHM0305015	VGHM0305050	M3X0.5	6H	56	11.0	3.5	2.7	6	3	371
VGHM0407015	VGHM0407050	M4X0.7	6H	63	13.0	4.5	3.4	6	3	371
VGHM0508015	VGHM0508050	M5X0.8	6H	70	15.0	6.0	4.9	8	3	371
VGHM0610015	VGHM0610050	M6X1.0	6H	80	17.0	6.0	4.9	8	3	371
VGHM0810015	VGHM0810050	M8X1.0	6H	90	17.0	6.0	4.9	8	4	374
VGHM0812515	VGHM0812550	M8X1.25	6H	90	20.0	8.0	6.2	9	4	371
VGHM1010015	VGHM1010050	M10X1.0	6H	90	18.0	7.0	5.5	8	4	374
VGHM1012515	VGHM1012550	M10X1.25	6H	100	22.0	7.0	5.5	8	4	374
VGHM1015015	VGHM1015050	M10X1.5	6H	100	22.0	10.0	8.0	11	4	371
VGHM1210015	VGHM1210050	M12X1.0	6H	100	18.0	9.0	7.0	10	4	374
VGHM1212515	VGHM1212550	M12X1.25	6H	100	22.0	9.0	7.0	10	4	374
VGHM1215015	VGHM1215050	M12X1.5	6H	100	22.0	9.0	7.0	10	4	374
VGHM1217515	VGHM1217550	M12X1.75	6H	110	24.0	9.0	7.0	10	4	376
VGHM1415015	VGHM1415050	M14X1.5	6H	100	22.0	11.0	9.0	12	4	374
VGHM1420015	VGHM1420050	M14X2.0	6H	110	26.0	11.0	9.0	12	4	376
VGHM1615015	VGHM1615050	M16X1.5	6H	100	22.0	12.0	9.0	12	4	374
VGHM1620015	VGHM1620050	M16X2.0	6H	110	27.0	12.0	9.0	12	4	376
VGHM1815015	VGHM1815050	M18X1.5	6H	110	25.0	14.0	11.0	14	4	374
VGHM1825015	VGHM1825050	M18X2.5	6H	125	30.0	14.0	11.0	14	4	376
VGHM2015015	VGHM2015050	M20X1.5	6H	125	25.0	16.0	12.0	15	4	374
VGHM2025015	VGHM2025050	M20X2.5	6H	140	32.0	16.0	12.0	15	4	376
VGHM2215015	VGHM2215050	M22X1.5	6H	125	25.0	18.0	14.5	17	4	374
VGHM2225015	VGHM2225050	M22X2.5	6H	140	32.0	18.0	14.5	17	4	376
VGHM2415015	VGHM2415050	M24X1.5	6H	140	27.0	18.0	14.5	17	4	374
VGHM2420015	VGHM2420050	M24X2.0	6H	140	27.0	18.0	14.5	17	4	374
VGHM2430015	VGHM2430050	M24X3.0	6H	160	34.0	18.0	14.5	17	4	376

Low Carbon Steels	Medium Carbon Steels	High Carbon Steels	Alloy Steels	Hardened Steels			Stainless Steels	Tool Steels	Cast Steels	Cast Iron	Ductile Cast Iron	Copper	Brass	Brass Casting	Bronze	Aluminum Rolled	Aluminum Alloy Casting	Magnesium Alloy Casting	Zinc Alloy Casting	Titanium Alloys	Nickel Alloys	Thermo Setting Plastic	Thermo Plastic
C ~0.25%	C0.25% ~0.45%	C 0.45%~	SCM	25~45 HRc	45~55 HRc	50~60 HRc	SUS	SKD	SC	FC	FCD	Cu	Bs	BsC	BRZ	AL	AC,ADC	MC	ZDC				
○			○						○														

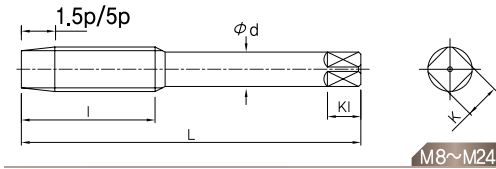
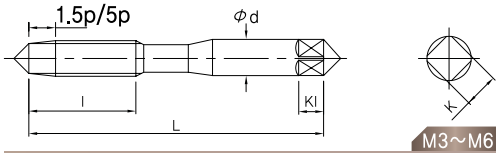

Uncoated for general use

- Designed for high performance of threading Cast Iron, Medium Carbon steel, Nonferrous metals and so on.



VGOM...Series

EDP NO.		Thread size	Limits	L Overall Length	l Thread Length	d Shank Diameter	K Square Width	KI Square Length	Flutes	DIN Type
1.5P	5P									
VGOM0305015	VGOM0305050	M3X0.5	6H	56	11.0	3.5	2.7	6	3	371
VGOM0407015	VGOM0407050	M4X0.7	6H	63	13.0	4.5	3.4	6	3	371
VGOM0508015	VGOM0508050	M5X0.8	6H	70	15.0	6.0	4.9	8	3	371
VGOM0610015	VGOM0610050	M6X1.0	6H	80	17.0	6.0	4.9	8	3	371
VGOM0810015	VGOM0810050	M8X1.0	6H	90	17.0	6.0	4.9	8	4	374
VGOM0812515	VGOM0812550	M8X1.25	6H	90	20.0	8.0	6.2	9	4	371
VGOM1010015	VGOM1010050	M10X1.0	6H	90	18.0	7.0	5.5	8	4	374
VGOM1012515	VGOM1012550	M10X1.25	6H	100	22.0	7.0	5.5	8	4	374
VGOM1015015	VGOM1015050	M10X1.5	6H	100	22.0	10.0	8.0	11	4	371
VGOM1210015	VGOM1210050	M12X1.0	6H	100	18.0	9.0	7.0	10	4	374
VGOM1212515	VGOM1212550	M12X1.25	6H	100	22.0	9.0	7.0	10	4	374
VGOM1215015	VGOM1215050	M12X1.5	6H	100	22.0	9.0	7.0	10	4	374
VGOM1217515	VGOM1217550	M12X1.75	6H	110	24.0	9.0	7.0	10	4	376
VGOM1415015	VGOM1415050	M14X1.5	6H	100	22.0	11.0	9.0	12	4	374
VGOM1420015	VGOM1420050	M14X2.0	6H	110	26.0	11.0	9.0	12	4	376
VGOM1615015	VGOM1615050	M16X1.5	6H	100	22.0	12.0	9.0	12	4	374
VGOM1620015	VGOM1620050	M16X2.0	6H	110	27.0	12.0	9.0	12	4	376
VGOM1815015	VGOM1815050	M18X1.5	6H	110	25.0	14.0	11.0	14	4	374
VGOM1825015	VGOM1825050	M18X2.5	6H	125	30.0	14.0	11.0	14	4	376
VGOM2015015	VGOM2015050	M20X1.5	6H	125	25.0	16.0	12.0	15	4	374
VGOM2025015	VGOM2025050	M20X2.5	6H	140	32.0	16.0	12.0	15	4	376
VGOM2215015	VGOM2215050	M22X1.5	6H	125	25.0	18.0	14.5	17	4	374
VGOM2225015	VGOM2225050	M22X2.5	6H	140	32.0	18.0	14.5	17	4	376
VGOM2415015	VGOM2415050	M24X1.5	6H	140	27.0	18.0	14.5	17	4	374
VGOM2420015	VGOM2420050	M24X2.0	6H	140	27.0	18.0	14.5	17	4	374
VGOM2430015	VGOM2430050	M24X3.0	6H	160	34.0	18.0	14.5	17	4	376

Low Carbon Steels	Medium Carbon Steels	High Carbon Steels	Alloy Steels	Hardened Steels			Stainless Steels	Tool Steels	Cast Steels	Cast Iron	Ductile Cast Iron	Copper	Brass	Brass Casting	Bronze	Aluminum Rolled	Aluminum Alloy Casting	Magnesium Alloy Casting	Zinc Alloy Casting	Titanium Alloys	Nickel Alloys	Thermo Setting Plastic	Thermo Plastic
C ~0.25%	C0.25% ~0.45%	C 0.45%~	SCM	25~45 HRc	45~55 HRc	50~60 HRc	SUS	SKD	SC	FC	FCD	Cu	Bs	BsC	BRZ	AL	AC,ADC	MC	ZDC				
	○										○		○	○	○	○	○	○	○				

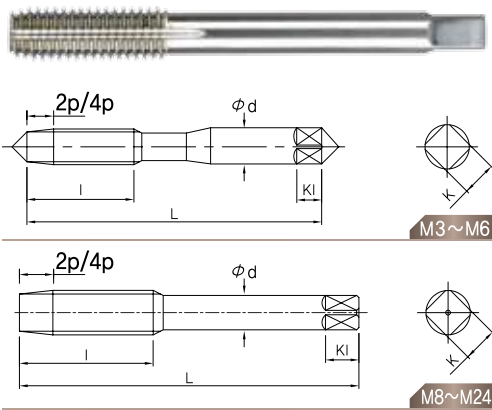

Uncoated for general use

- Designed for high performance of threading Aluminum, Zinc, Copper and other Nonferrous alloys.



VMOM...Series



EDP NO.		Thread size	Limits	L	l	d	K	KI	Oil groove
2P	4P			Overall Length	Thread Length	Shank Diameter	Square Width	Square Length	
VMOM0305020S	-	M3x0.5	6HX	56	11	3.5	2.7	6	1
VMOM0305020M	VMOM0305040M	M3x0.5	6HX	56	11	3.5	2.7	6	4
VMOM0407020S	-	M4x0.7	6HX	63	13	4.5	3.4	6	1
VMOM0407020M	VMOM0407040M	M4x0.7	6HX	63	13	4.5	3.4	6	4
VMOM0508020S	-	M5x0.8	6HX	70	15	6.0	4.9	8	1
VMOM0508020M	VMOM0508040M	M5x0.8	6HX	70	15	6.0	4.9	8	4
VMOM0610020S	-	M6x1.0	6HX	80	17	6.0	4.9	8	1
VMOM0610020M	VMOM0610040M	M6x1.0	6HX	80	17	6.0	4.9	8	4
VMOM0810020S	-	M8x1.0	6HX	90	17	6.0	4.9	8	1
VMOM0810020M	VMOM0810040M	M8x1.0	6HX	90	17	6.0	4.9	8	4
VMOM0812520S	-	M8x1.25	6HX	90	20	8.0	6.2	9	1
VMOM0812520M	VMOM0812540M	M8x1.25	6HX	90	20	8.0	6.2	9	4
VMOM1010020S	-	M10x1.0	6HX	90	18	7.0	5.5	8	1
VMOM1010020M	VMOM1010040M	M10x1.0	6HX	90	18	7.0	5.5	8	4
VMOM1012520S	-	M10x1.25	6HX	100	22	7.0	5.5	8	1
VMOM1012520M	VMOM1012540M	M10x1.25	6HX	100	22	7.0	5.5	8	4
VMOM1015020S	-	M10x1.5	6HX	100	22	10.0	8.0	11	1
VMOM1015020M	VMOM1015040M	M10x1.5	6HX	100	22	10.0	8.0	11	4
VMOM1210020S	-	M12x1.0	6HX	100	18	9.0	7.0	10	1
VMOM1210020M	VMOM1210040M	M12x1.0	6HX	100	18	9.0	7.0	10	4
VMOM1212520S	-	M12x1.25	6HX	100	22	9.0	7.0	10	1
VMOM1212520M	VMOM1212540M	M12x1.25	6HX	100	22	9.0	7.0	10	4
VMOM1215020S	-	M12x1.5	6HX	100	22	9.0	7.0	10	1
VMOM1215020M	VMOM1215040M	M12x1.5	6HX	100	22	9.0	7.0	10	4
VMOM1217520S	-	M12x1.75	6HX	110	24	9.0	7.0	10	1
VMOM1217520M	VMOM1217540M	M12x1.75	6HX	110	24	9.0	7.0	10	4

Low Carbon Steels	Medium Carbon Steels	High Carbon Steels	Alloy Steels	Hardened Steels			Stainless Steels	Tool Steels	Cast Steels	Cast Iron	Ductile Cast Iron	Copper	Brass	Brass Casting	Bronze	Aluminum Rolled	Aluminum Alloy Casting	Magnesium Alloy Casting	Zinc Alloy Casting	Titanium Alloys	Nickel Alloys	Thermo Setting Plastic	Thermo Plastic
C ~0,25%	C 0,25% ~0,45%	C 0,45%~	SCM	25~45 HRc	45~55 HRc	50~60 HRc	SUS	SKD	SC	FC	FCD	Cu	Bs	BsC	BRZ	AL	AC,ADC	MC	ZDC				
												○	○	○	○	○	○		◎				

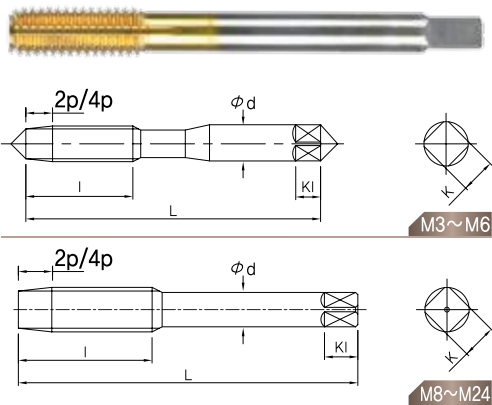

TiN coating for general use

- It is applicable regardless of steel or Nonferrous alloys.
- By applying TiCN coating, it provides stable and highly efficient operation due to enhanced durability.



VMTM...Series

EDP NO.		Thread Size	Limits	L	l	d	K	KI	Oil groove
2P	4P			Overall Length	Thread Length	Shank Diameter	Square Width	Square Length	
VMTM0305020S	-	M3x0.5	6HX	56	11	3.5	2.7	6	1
VMTM0305020M	VMTM0305040M	M3x0.5	6HX	56	11	3.5	2.7	6	4
VMTM0407020S	-	M4x0.7	6HX	63	13	4.5	3.4	6	1
VMTM0407020M	VMTM0407040M	M4x0.7	6HX	63	13	4.5	3.4	6	4
VMTM0508020S	-	M5x0.8	6HX	70	15	6.0	4.9	8	1
VMTM0508020M	VMTM0508040M	M5x0.8	6HX	70	15	6.0	4.9	8	4
VMTM0610020S	-	M6x1.0	6HX	80	17	6.0	4.9	8	1
VMTM0610020M	VMTM0610040M	M6x1.0	6HX	80	17	6.0	4.9	8	4
VMTM0810020S	-	M8x1.0	6HX	90	17	6.0	4.9	8	1
VMTM0810020M	VMTM0810040M	M8x1.0	6HX	90	17	6.0	4.9	8	4
VMTM0812520S	-	M8x1.25	6HX	90	20	8.0	6.2	9	1
VMTM0812520M	VMTM0812540M	M8x1.25	6HX	90	20	8.0	6.2	9	4
VMTM1010020S	-	M10x1.0	6HX	90	18	7.0	5.5	8	1
VMTM1010020M	VMTM1010040M	M10x1.0	6HX	90	18	7.0	5.5	8	4
VMTM1012520S	-	M10x1.25	6HX	100	22	7.0	5.5	8	1
VMTM1012520M	VMTM1012540M	M10x1.25	6HX	100	22	7.0	5.5	8	4
VMTM1015020S	-	M10x1.5	6HX	100	22	10.0	8.0	11	1
VMTM1015020M	VMTM1015040M	M10x1.5	6HX	100	22	10.0	8.0	11	4
VMTM1210020S	-	M12x1.0	6HX	100	18	9.0	7.0	10	1
VMTM1210020M	VMTM1210040M	M12x1.0	6HX	100	18	9.0	7.0	10	4
VMTM1212520S	-	M12x1.25	6HX	100	22	9.0	7.0	10	1
VMTM1212520M	VMTM1212540M	M12x1.25	6HX	100	22	9.0	7.0	10	4
VMTM1215020S	-	M12x1.5	6HX	100	22	9.0	7.0	10	1
VMTM1215020M	VMTM1215040M	M12x1.5	6HX	100	22	9.0	7.0	10	4
VMTM1217520S	-	M12x1.75	6HX	110	24	9.0	7.0	10	1
VMTM1217520M	VMTM1217540M	M12x1.75	6HX	110	24	9.0	7.0	10	4

Low Carbon Steels	Medium Carbon Steels	High Carbon Steels	Alloy Steels	Hardened Steels			Stainless Steels	Tool Steels	Cast Steels	Cast Iron	Ductile Cast Iron	Copper	Brass	Brass Casting	Bronze	Aluminum Rolled	Aluminum Alloy Casting	Magnesium Alloy Casting	Zinc Alloy Casting	Titanium Alloys	Nickel Alloys	Thermo Setting Plastic	Thermo Plastic
C ~0.25%	C 0.25% ~0.45%	C 0.45%~	SCM	25~45 HRc	45~55 HRc	50~60 HRc	SUS	SKD	SC	FC	FCD	Cu	Bs	BsC	BRZ	AL	AC,ADC	MC	ZDC				
○	○	○	○				◎	○	○		○	○	○	○									

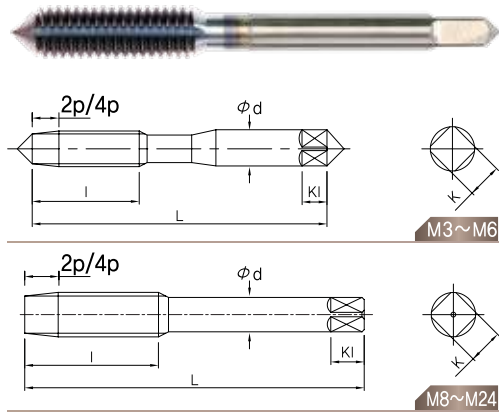

TiCN coating for general use

- It is applicable regardless of steel or Nonferrous alloys.
- By applying TiCN coating, it provides stable and highly efficient operation due to enhanced durability.

VMCM...Series



EDP NO.		Thread Size	Limits	L	l	d	K	KI	Oil groove
2P	4P			Overall Length	Thread Length	Shank Diameter	Square Width	Square Length	
VMCM0305020S	-	M3x0.5	6HX	56	11	3.5	2.7	6	1
VMCM0305020M	VMCM0305040M	M3x0.5	6HX	56	11	3.5	2.7	6	4
VMCM0407020S	-	M4x0.7	6HX	63	13	4.5	3.4	6	1
VMCM0407020M	VMCM0407040M	M4x0.7	6HX	63	13	4.5	3.4	6	4
VMCM0508020S	-	M5x0.8	6HX	70	15	6.0	4.9	8	1
VMCM0508020M	VMCM0508040M	M5x0.8	6HX	70	15	6.0	4.9	8	4
VMCM0610020S	-	M6x1.0	6HX	80	17	6.0	4.9	8	1
VMCM0610020M	VMCM0610040M	M6x1.0	6HX	80	17	6.0	4.9	8	4
VMCM0810020S	-	M8x1.0	6HX	90	17	6.0	4.9	8	1
VMCM0810020M	VMCM0810040M	M8x1.0	6HX	90	17	6.0	4.9	8	4
VMCM0812520S	-	M8x1.25	6HX	90	20	8.0	6.2	9	1
VMCM0812520M	VMCM0812540M	M8x1.25	6HX	90	20	8.0	6.2	9	4
VMCM1010020S	-	M10x1.0	6HX	90	18	7.0	5.5	8	1
VMCM1010020M	VMCM1010040M	M10x1.0	6HX	90	18	7.0	5.5	8	4
VMCM1012520S	-	M10x1.25	6HX	100	22	7.0	5.5	8	1
VMCM1012520M	VMCM1012540M	M10x1.25	6HX	100	22	7.0	5.5	8	4
VMCM1015020S	-	M10x1.5	6HX	100	22	10.0	8.0	11	1
VMCM1015020M	VMCM1015040M	M10x1.5	6HX	100	22	10.0	8.0	11	4
VMCM1210020S	-	M12x1.0	6HX	100	18	9.0	7.0	10	1
VMCM1210020M	VMCM1210040M	M12x1.0	6HX	100	18	9.0	7.0	10	4
VMCM1212520S	-	M12x1.25	6HX	100	22	9.0	7.0	10	1
VMCM1212520M	VMCM1212540M	M12x1.25	6HX	100	22	9.0	7.0	10	4
VMCM1215020S	-	M12x1.5	6HX	100	22	9.0	7.0	10	1
VMCM1215020M	VMCM1215040M	M12x1.5	6HX	100	22	9.0	7.0	10	4
VMCM1217520S	-	M12x1.75	6HX	110	24	9.0	7.0	10	1
VMCM1217520M	VMCM1217540M	M12x1.75	6HX	110	24	9.0	7.0	10	4

Low Carbon Steels	Medium Carbon Steels	High Carbon Steels	Alloy Steels	Hardened Steels			Stainless Steels	Tool Steels	Cast Steels	Cast Iron	Ductile Cast Iron	Copper	Brass	Brass Casting	Bronze	Aluminum Rolled	Aluminum Alloy Casting	Magnesium Alloy Casting	Zinc Alloy Casting	Titanium Alloys	Nickel Alloys	Thermo Setting Plastic	Thermo Plastic
C ~0.25%	C 0.25% ~0.45%	C 0.45%~	SCM	25~45 HRc	45~55 HRc	50~60 HRc	SUS	SKD	SC	FC	FCD	Cu	Bs	BsC	BRZ	AL	AC,ADC	MC	ZDC				
⊙	⊙	⊙	⊙				⊙					⊙	⊙	⊙		⊙	⊙		⊙				

Recommended tapping speeds and lubricants DIN STANDARD

Tapping speeds depend on very important factors such as material and type of tap, chamfer length, dimension of holes, work materials and fluids.

Users need to check every aspect before applying it.

Moreover, lubricant, cooling and abrasion resistance are three important factors affecting cutting fluids. Therefore, users should provide enough fluids during the tapping process.

Standard Recommended tapping speeds and applicable lubricants

Work Material		Recommended tapping speeds(m/min)				lubricants			
		STRAIGHT TAPS	SPIRAL TAPS	POINT TAPS	ROLL TAPS	Non water soluble	water soluble	Semi dry	Dry
Low Carbon Steels	C ~0.25%	8-13	8-13	15-25	8-13	◎	○	△	△
Medium Carbon Steels	C0.25% ~0.45%	7-12	7-12	10-15	7-10	◎	○	△	△
High Carbon Steels	C 0.45%~	6-9	6-9	8-13	5-8	◎	○	△	△
Alloy Steels	SCM	7-12	7-12	10-15	5-8	◎	△	△	△
Hardened steels	25~45 HRc	3-5 (4-8)	3-5 (4-8)	4-6 (6-10)	-	◎	△	-	-
Stainless Steels	SUS	4-7	5-8	8-13	5-10	◎	○	-	-
Precipitation Hardened Steels	SUS630 SUS631	3-5	3-5	4-6	-	◎	-	-	-
Tool Steels	SKD	6-9	6-9	7-10	-	◎	-	-	-
Cast Steels	SC	6-11	6-11	10-15	-	◎	○	-	-
Cast Iron	FC	10-15	-	-	-	◎	○	○	○
Ductile Cast Iron	FCD	7-12	7-12	10-20	-	◎	○	○	-
Copper	Cu	6-9	6-11	7-12	7-12	○	○	-	-
Brass, Brass Casting	Bs, Bsc	10-15	10-20	15-25	7-12	○	○	○	○
Bronze, Bronze Casting	BRZ	6-11	6-11	10-20	7-12	○	○	-	-
Aluminum Rolled	AL	10-20	10-20	15-25	10-20	◎	○	△	-
Aluminum AlloyCasting	AL, ADC	10-15	10-15	15-20	10-25	◎	○	△	-
Magnesium Alloy Casting	MC	7-12	7-12	10-15	-	◎	○	○	-
Zinc Alloy Casting	ZDC	1-12	7-12	10-15	7-12	◎	○	△	-
Thermo SettingPlastic	Bakelite, Phenol Epoxy	10-20	-	-	-	-	○	○	○
Thermo Plastic	Vinyl Chloride Nylon	10-20	10-15	10-20	-	-	○	○	○

◎Ideal ○Good △Applicable -Not Applicable

Best Tools, Best Choice For Your Vision



WIDIN's Local Business Sites

- Argentina
- Australia
- Austria
- Belgium
- Brazil
- Canada
- China
- Colombia
- Czech
- Denmark
- Egypt
- France
- Germany
- Greece
- Hong Kong
- Hungary
- India
- Indonesia
- Iran
- Italy
- Japan
- Malaysia
- Mexico
- Netherlands
- New Zealand
- Norway
- Philippines
- Poland
- Portugal
- Russia
- Singapore
- Slovenia
- South Africa
- Spain
- Sweden
- Switzerland
- Thailand
- Turkey
- U.S.A
- United Kingdom
- Vietnam

 Head Office(Changwon Factory)	TEL. 82-55-286-0905	FAX. 82-55-286-0978
 Chicago Office	TEL. 1-847-947-8320	FAX. 1-847-947-8322
 Shanghai Office	TEL. 86-21-5831-8103	FAX. 86-2-5831-8153
 Vietnam Office	TEL. 84-4-6287-3839	FAX. 84-4-6287-3828
1 Seoul Office	TEL. 82-02-2679-0980	FAX. 82-02-2679-0970
2 Shihwa Office	TEL. 82-31-430-5446	FAX. 82-31-430-5579
3 Daegu Office	TEL. 82-53-604-0968	FAX. 82-53-604-0932
4 Busan Office	TEL. 82-51-319-0914	FAX. 82-51-319-0976
5 Gwangju Office	TEL. 82-62-961-0985	FAX. 82-62-961-0982
6 Changwon Office	TEL. 82-55-277-9911	FAX. 82-55-237-0904



Head office & Changwon Factory

172, Sahwa-ro, Uichang-gu, Changwon-si, Gyeongsangnam-do, Korea [51389]

Chicago Office(WIDIN, INC.)

1801 Hicks Rd, Unit B Rolling Meadow il 60008

Shanghai Office(WIDIN Shanghai Trade Co.,Ltd.)

#303, NO 6818-10, Zhong Chun RD Min Hang District, Shanghai, China 201101

Vietnam Office(WIDIN VINA Co.,Ltd.)

Room A308, 3rd floor, The Manor Tower, Me Tri Rd, My Dinh Ward, Nam Tu Liem Dist, Hanoi City, Vietnam



Head Office & Changwon Factory

172, Sahwa-ro, Uichang-gu, Changwon-si, Gyeongsangnam-do, Korea 641-847
TEL : 82-55-286-0905 FAX : 82-55-286-0978

WIDIN TEC CO., LTD.

44, Waryong-ro 66-gil, Seo-gu, Daegu, Korea 703-833
TEL : 82-53-341-8909 FAX : 82-53-353-9809

Chicago Office(WIDIN, INC.)

1801 HICKS RD, UNIT B ROLLING MEADOW IL 60008
TEL : 1-847-947-8320 FAX : 1-847-947-8322

Shanghai Office(WIDIN(SHANGHAI)TRADE CO., LTD.)

B-901, NO 400 PUDIAN ROAD, PUDONG NEW DISTRICT, SHANGHAI, CHINA
TEL : 86-21-5831-8103 FAX : 86-2-5831-8153

www.iwidin.com